

# Detached Deck Size \_\_\_\_\_ x \_\_\_\_\_

Exterior Guard Construction as per Supplementary Standard SB - 7 "Guards for Housing and Small Buildings" of the 2012 Building Code Compendium  
or

Provide alternative designed by a Professional Engineer along with appropriate shop drawings.

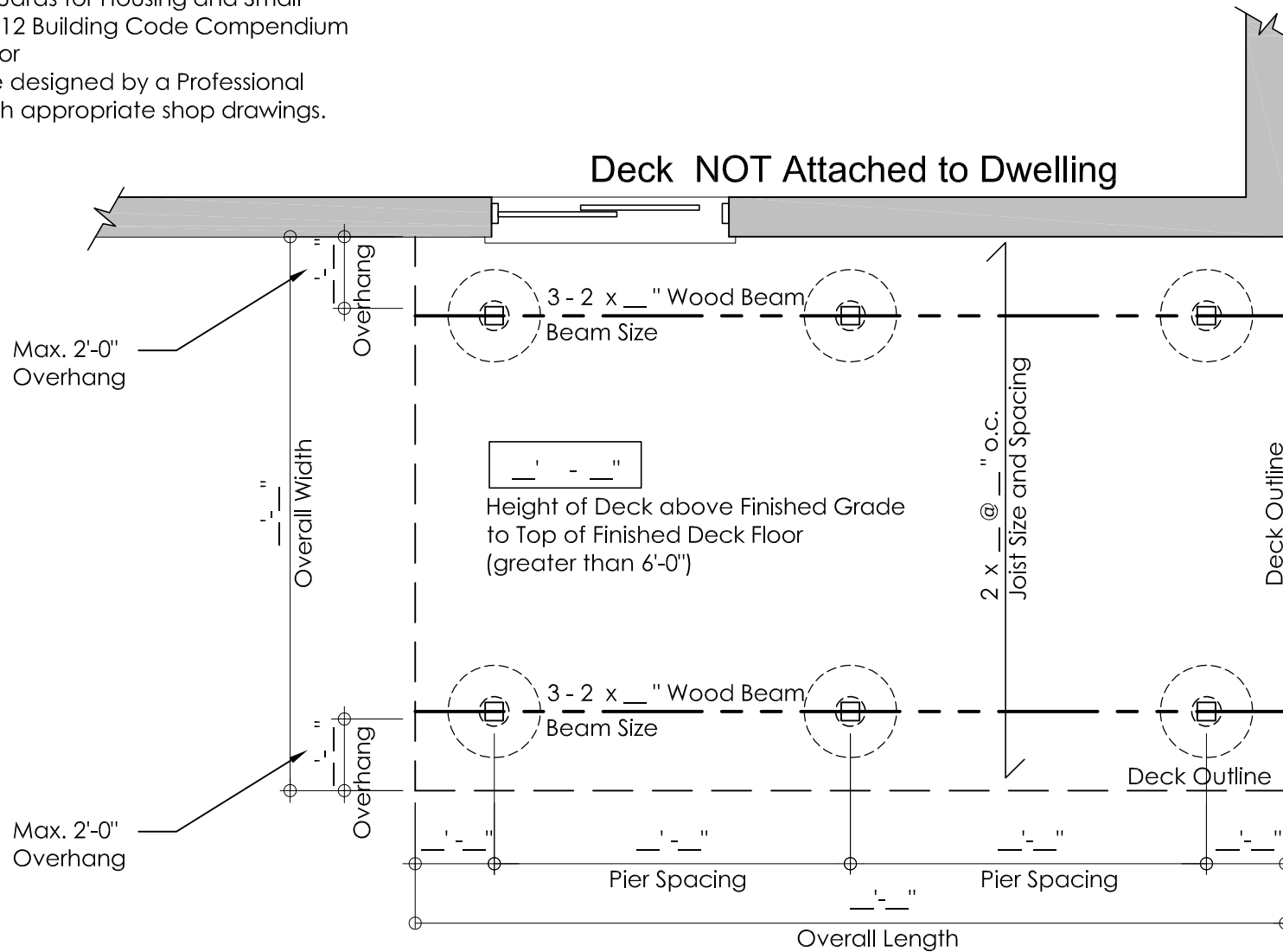

**Notes:**

- 1) When Deck is greater than **6'-0" (1.8m)** above Fin. Grade, then 6" x 6" Posts shall be Supported on Concrete Piers with Bigfoot Base, Concrete Pad Footings or Approved Helical Piles.
- 2) Beam Size will be Determined by Distance between Supporting Posts

**NOTE:**  
It is the Contractor's responsibility to ensure that all construction conforms to the requirements of the Ontario Building Code. Notations made on these drawings are for your information and assistance only and do not necessarily comment on all areas of construction.



**Detached Deck**  
Greater than 6'-0" (1.8m) in Height  
*Deck Plan* Scale: nts

DRAWN BY: E.P.

DATE: 14/02/23

**DD-1**  
SHEET

**Notes:**

- 1) When Deck is greater than **6'-0"** above Fin. Grade, then 6" x 6" Posts shall be Supported on Concrete Piers with Bigfoot, Concrete Pad Footings or Approved Helical Piles.
- 2) Lumber for Guard Systems and Floor Systems shall be Decay-Resistant Lumber
- 3) Footing Inspection Required Prior to Pouring Concrete
- 4) Framing Inspection required prior to installing Deck Boards

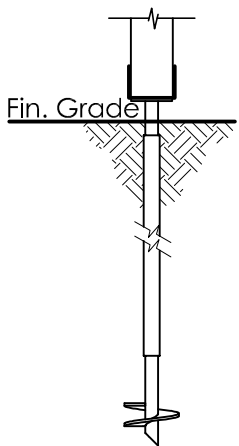

**Helical Piles**

Must be CCMC Approved Engineers report required after installation.

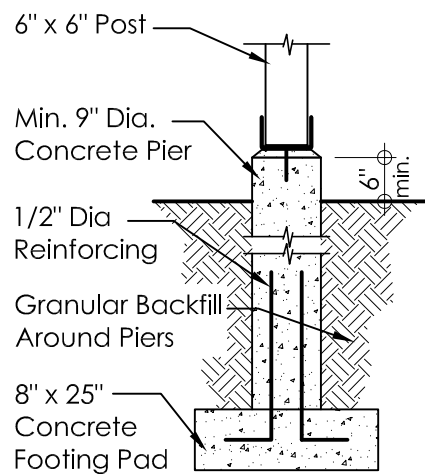

**Concrete Pad**

Frost Depth 4'-6" or per Soils Report in Valid Subdivision

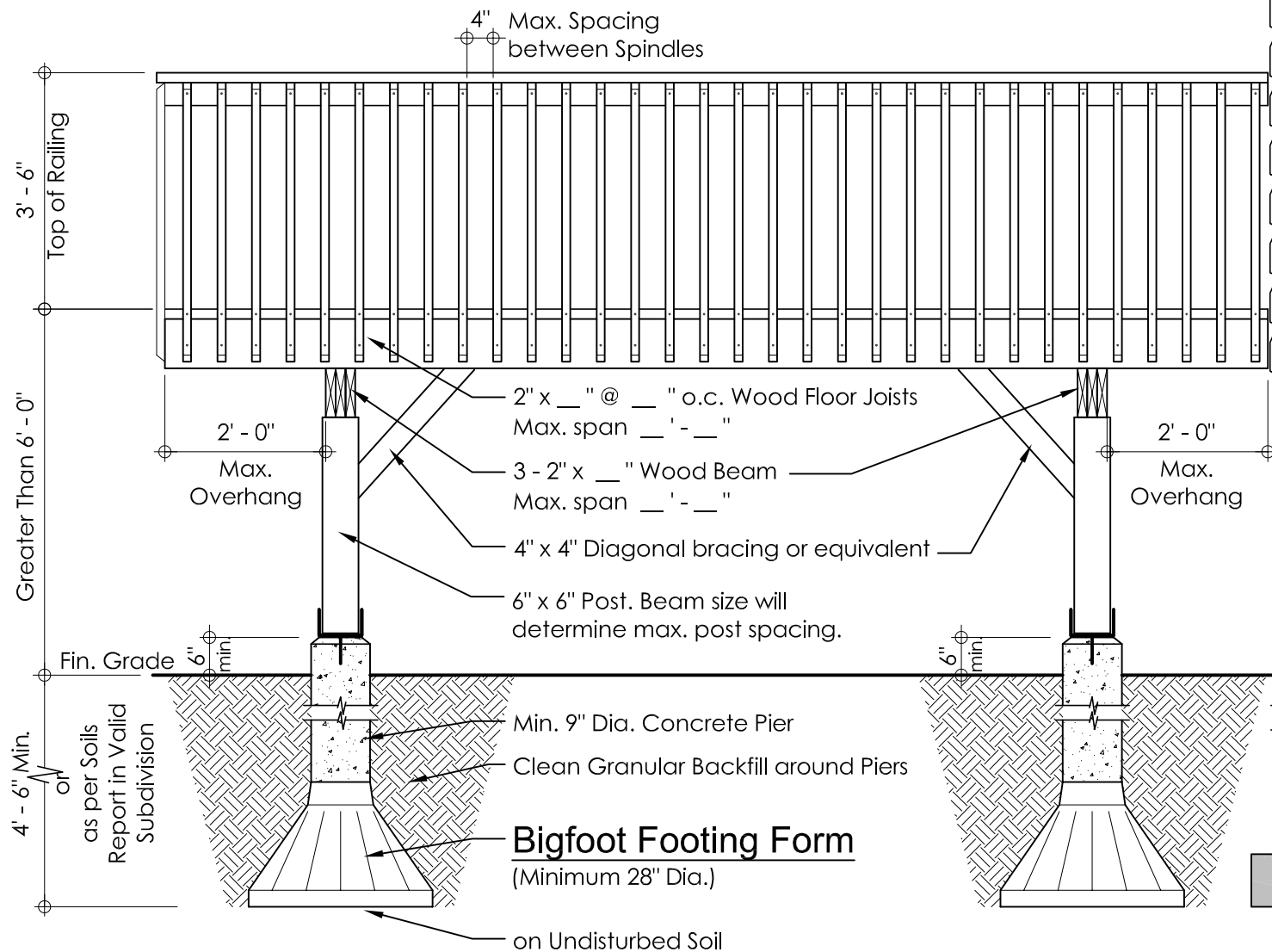

Deck NOT Attached to Dwelling

**NOTE:**

It is the Contractor's responsibility to ensure that all construction conforms to the requirements of the Ontario Building Code. Notations made on these drawings are for your information and assistance only and do not necessarily comment on all areas of construction.



**Detached Deck**

Greater than 6'-0" (1.8m) in Height

*Detail* Scale: nts

DRAWN BY: E.P.

DATE: 14/02/23

**DD-2**  
SHEET